

- Le Lac Plat 3 -

132

May, A.D., Nineteen Hundred Eighty Seven

Sheet Three Of Three

A Part Of Le Lac, A Planned Unit Development, Lying In Sections 34 and 35, Township 46 South, Range 42 East, Palm Beach County, Florida
Being A Replat Of A Portion Of "Le Lac", (P.B. 39, Pp. 145 & 146), Public Records, Palm Beach County, Florida

Match Line
See Sheet 2 of 3

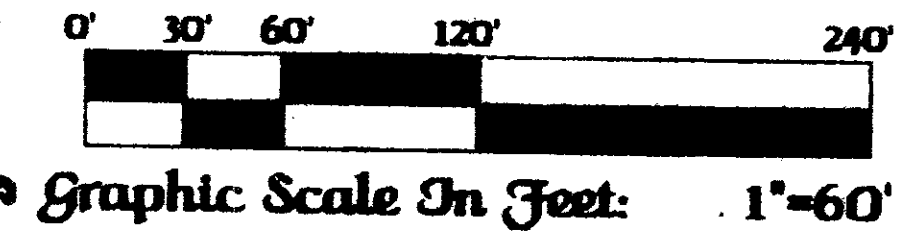
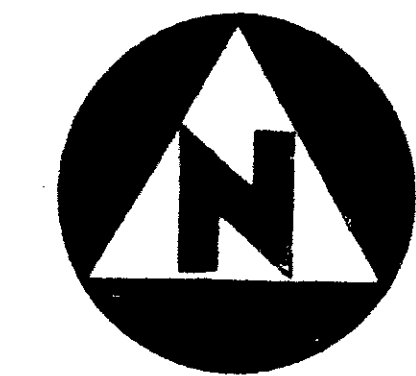
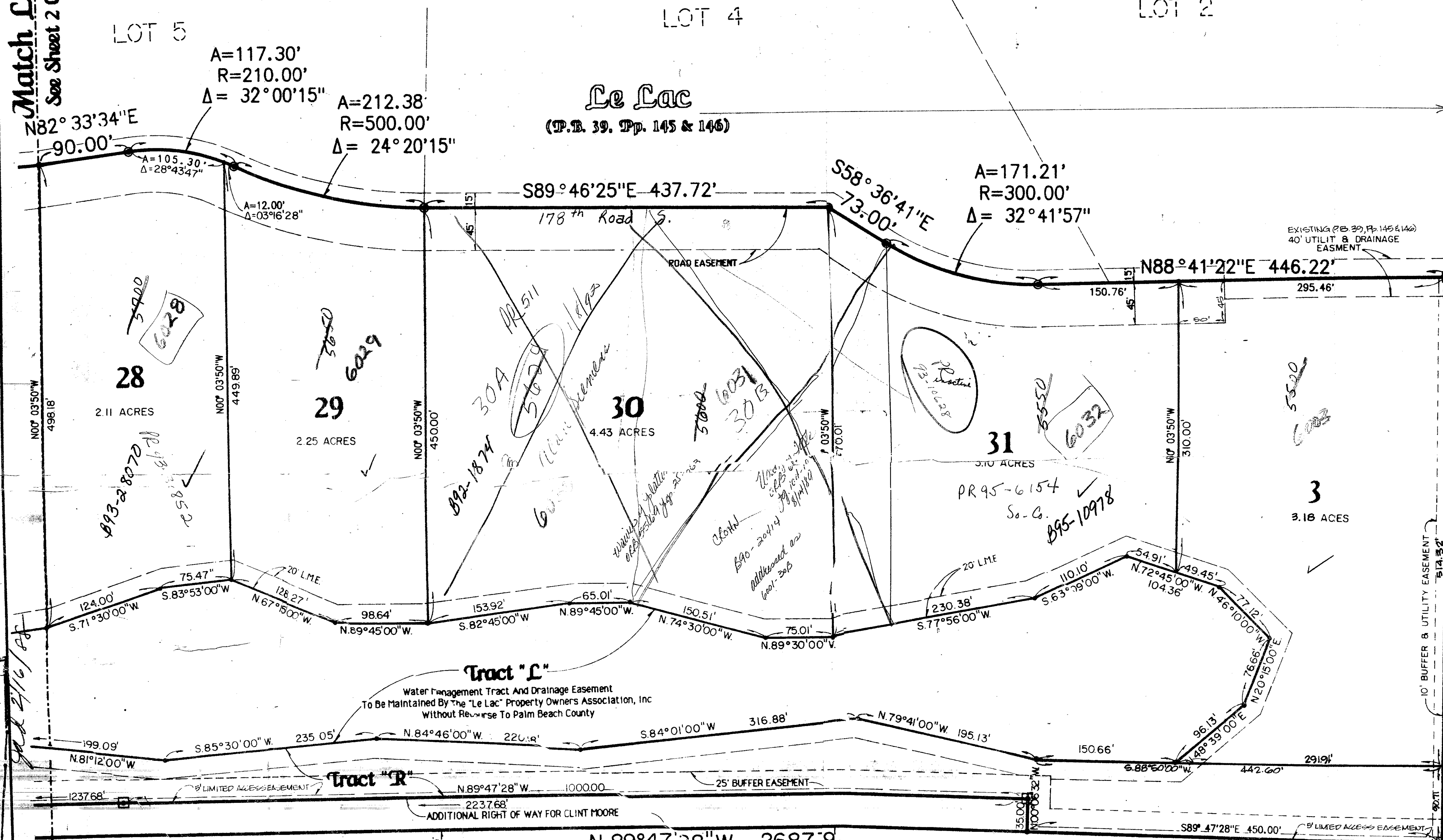

Lake Worth Drainage District Equalizing Canal E-3
(P.B. 4079, Pp. 1-5)

Polo Club Plat 1
(P.B. 52, Pages 35 & 36)

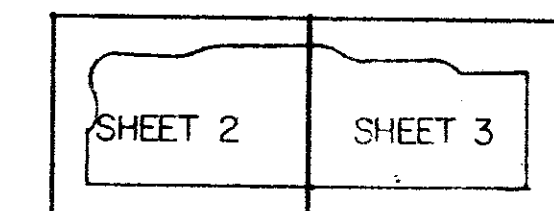

KEY MAP
not to scale

0272-001

This instrument was prepared by Wm. R. Van Campen, R.L.S., for the offices of Bench Mark Land Surveying & Mapping, Inc., West Blue Heron Boulevard, Suite 121, Riviera Beach, FL.

BENCH MARK
LAND SURVEYING & MAPPING
WEST PALM BEACH, FLORIDA RIVIERA BEACH

-Record Plat-
Le Lac Plat 3

OWN SCALE SIZE DATE SHEET

58/132

ADD. BY [Signature]
CHECKED BY [Signature]

Old Clint Moore Road
(P.B. 2, Pp. 82)
(P.B. 784, Pp. 153)
(P.B. 448, Pp. 159)
LE LAC PLAT
Lake Worth Drainage District Lateral Canal L-4

Match Line
See Sheet 2 of 3

- Legend:**
- - Denotes a permanent reference monument (P.R.M.)
 - - Denotes a permanent control point (P.C.P.)
 - - - - - Denotes a drainage easement.
 - - - - - Denotes a utility easement.
 - - - - - Denotes a limited access easement.
 - - - - - Denotes a lake maintenance easement.

SUBDIVISION
PAGE 192
FLOOD MAP # 2010
QUAD #
PUD NAME